

► Universal 3D measurement software and solutions

Enhance manufacturing efficiency by offering a collaborative and universal 3D metrology digital platform



ANY DATA | ANY TECHNOLOGY | ANY APPLICATION

About Metrologic Group



Metrologic Group empowers its customers to solve complex 3D measurement challenges and boost their measuring device operation using the most innovative hardware, independent 3D measuring software solutions and dedicated electronics.

In the 3D metrology market since 1980, with offices and distributors throughout the world, Metrologic Group solutions are considered the reference in industries like automotive, aerospace transportation, energy, watchmaking and medical, to name a few.

The company became part of Sandvik Group in 2018, yet another step towards a digital manufacturing offering that will help drive real impact on the production floor and beyond, streamlining the entire manufacturing value chain.

Metrologic Group by the Numbers

30+

Countries with Local Support

60+

Countries with Metrolog X4 Users

120+

Direct Machine Interfaces

19

Interface Languages

4.000+

Global Users

Global Metrology Services

Metrologic Group designs 3D measurement software solutions, electronic devices and related services. The company provides innovative industrial solutions and products for measurements, where accuracy ranges from micrometers to millimeters.



Three innovative product lines

X4 Core

Universal 3D inspection software

Metrolog X4
Silma X4

- Programming services
- Service delivery
- CMM Calibration & Verification

X4 i-Robot

Robotic inspection: Inline, Bypass cells, Nearline/ Sideline

Metrolog X4 i-Robot
Silma X4 i-Robot

- Programming services
- Service delivery

X4 i-Tech

Special machines, custom installation, in-situ
No measurement robots involved

Metrolog X4

- Programming services
- Service delivery
- Engineering Intelligence

Your End-to-End solution is ready for the future

Get the most comprehensive 3D inspection solutions to streamline your process.

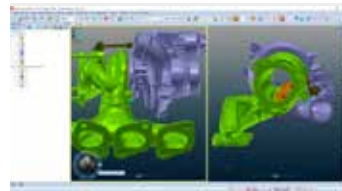
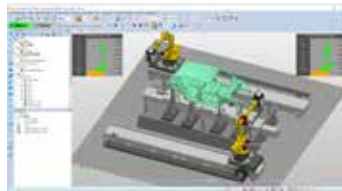
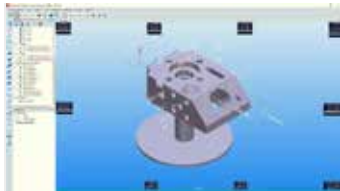

Planner X4

- Offline Preparation of your measurements process
- Identify which features you want to measure
- Compute using basic 2D, embedded PMI data or importing different inspection planning files
- Import any CAD file, any data
- Prepare the features to be measured
- Prepare View and Report

Silma X4

- Smart virtual programming
- Quickly generate robot and CMM paths
- Acquisition group creation
- Set the parameters for extraction
- Potential collision detection and automatic avoidance
- Path optimization
- Advanced rewind security move

Metrolog X4

- Compatible with all CAD file types
- Best-in-class GD&T computation,
- point cloud analysis and visualization
- Powerful 64-bit data processing
- Precise and extensive results analysis
- Customizable interface and report editor
- Export results in any format

X4 Manager Suite

- Visualize measurement results and data on mobile devices
- Take control of X4 software while away from your computer
- View live inspection results
- Simple touch-screen functionality



Retrofit solutions

Transform Outdated Equipment into Valuable Assets with a Software Upgrade and CMM Retrofit

When considering a retrofit, software is often the tool most in need of an update. An upgrade or retrofit can be a cost-effective way to counteract machine obsolescence and transform your CMM by restoring its full performance. Discover how an upgrade or retrofit could help your organization drive manufacturing productivity and streamline your 3D metrology process.



Value added solutions

Improve your 3D control experience



i-Viewer

Improve manufacturing decision-making

Providing meaningful feedback on manufactured parts helps the engineering team make sound decisions and avoid critical errors.



i-Holo

Augmented 3D inspection

i-Holo offer the first 3D measurement mixed reality solution of the market. Based on the Microsoft™ HoloLens™ platform.



i-Remote

Stay in command of your inspection process

Use i-Remote to simplify your workflow and let you handle quality inspection and dimensional analysis away from your computer.



i-Monitor

Monitor performance and occupation rate

i-Monitor provide you all the information you need, in a centralized location, accessible from any web browser and for all your live machine access.

Training

Software training sessions

We offers several training programs to meet your discovery needs, training or specialization on Metrolog and/or Silma. These programs were designed to meet the new needs of business training: time optimization, organizational flexibility, adaptation to the specific needs of the participants.

Calibration & services

CMM support expertise

Our services experts team are available to move all around the world. No matter where your measuring equipment is, we can ensure the maintenance and calibration of your precious machines. Our services specialists will do everything possible to advise and help you.

Why choosing Metrologic Group?

- | | | |
|--|--|---|
| <ul style="list-style-type: none"> • Unique provider for every measurement need • Consultative help for pain points • CMM upgrade and retrofit, and calibration service | <ul style="list-style-type: none"> • Modular software concept easily adjusts to future needs • New version released twice a year to deliver the latest technologies and standards in measuring devices | <p>With a presence on all continents, our teams are available for:</p> <ul style="list-style-type: none"> • Training / Hotline Tech Support • Calibration and expertise in all types of CMM • After-Sale Service |
|--|--|---|

Let Us Show You How It Works

Contact us for a free onsite demo. Using your own part and measuring device, we'll demonstrate specifically how we can help make your processes more efficient, cost effective and easier.

Interested in learning more about our solution

Visit our website directly at: www.metrologic.group